

STRAND-CAPITOL PERFORMING ARTS CENTER

50 N George St
York, PA 17401
(P) 717-846-1155 (F) 717-843-1208
www.strandcapitol.org

10-10-06 TECHNICAL INFORMATION

TECHNICAL CONTACT: Production Express, Inc. Steven Shelley (P) 717-854-5265 (F) 717-843-7031
E-mail salesinfo@proexp.com
Production Manager Judi Miller (P) 717-495-8761 (F) 717-843-7031
E-mail judi@proexp.com

GENERAL INFORMATION:

Proscenium Width: 42'-0"

Proscenium Height: 28'-0" to masonry
21'-6" to Grand Drape/Valance

Stage Depth: 37'-1" smoke pocket to upstage wall
37'-8" proscenium line to upstage wall

Stage Width: 77'-5" stage left wall to stage right wall
74'-5" stage left locking rail to stage right wall
14'-11" proscenium line to stage left locking rail
17'-6" proscenium line to stage right wall
35'-11" centerline to stage left locking rail
38'-6" centerline to stage right wall
29'-0" centerline to edge of stage left fly floor
29'-5" centerline to edge of stage right fly floor
58'-5" edge of stage left fly floor to edge of stage right fly floor

Stage Apron: 4'-0" proscenium line to edge of apron

Orchestra Pit: Approximate capacity of 23 musicians
8'-3" below stage
10'-7" deep at centerline, 5'-0" deep at sides, extends 3'-0" under stage
42'-6" wide

Fly Floors: 35'-0" above stage
26'-9" clear from stage to AC duct under stage left fly floor
25'-9" clear from stage to AC duct under stage right fly floor

Grid Iron: 70'-0" above stage

Scene Dock: Accessible stage right through a 12'-0" wide by 19'-0" high roll-up door, the 34'-0" long by 18'-0" wide-open area can be used for load-in/out staging or as additional scenery storage.

Loading Door: 10'-0" wide x 12'-0" high, at street level, stage right.

STAGE RIGGING SYSTEM:

Forty-nine (49) five-line, tee-bar guided, single purchase line sets, each with 1900# capacity, on 8" centers, operated from stage left. Each line set has a 52'-0" long truss batten.

Fire curtain is located 3" upstage of proscenium.

STRAND-CAPITOL PERFORMING ARTS CENTER

House curtain is located 1'-3" upstage of proscenium.

Line set #1 is located 2'-0" upstage of proscenium.

Line set #49 is located 37'-4" upstage of proscenium.

Line set low trim is 4'-0".

Line set high trim is 65'-0".

50,000# of counterweight is on hand. This includes pipe counterweight on each line set.

Misc. rigging equipment:

15 8" diameter, 3 sheave, upright hemp headblocks

40 8" diameter, upright hemp loft blocks

20 8" diameter, upright, cable loft blocks

Misc. 5/8" diameter Multiline II synthetic rope

STAGE DRAPERY:

2	Travelers, black velour, with 50% fullness	28'-0" high	52'-0" wide
6	Borders, black velour, sewn flat	15'-0" high	52'-0" wide
12	Legs, black velour, sewn flat	28'-0" high	8'-0" wide
1	Scrim, black, seamless sharktooth	28'-0" high	52'-0" wide
1	Cyclorama, seamless bleached muslin,	28'-0" high	52'-0" wide

STAGE LIGHTING DIMMING SYSTEM:

300 – 2.4 kW and 9 – 6.0 kW ETC *Sensor* dimmers in dimmer-per-circuit racks.

ETC *Insight 2x 108 channel* stage lighting control console.

ETCNet 2 Ethernet control system.

STAGE LIGHTING CIRCUIT DISTRIBUTION:

FOH Ceiling "Perches":

Each is a 12'-8" x 4'-4" platform suspended from the auditorium ceiling.

Each is located 30° to either side of the proscenium centerline.

58'-6" throw from center of perch to person standing at proscenium line, center center.

Throw angle is 39° from center of perch to person standing at proscenium line, center center.

Each has surface mount, vertical connector strip with flush mount, pin plug receptacles.

Stage Left:	24 – 20A (#1 - #24)	Stage Right:	24 – 20A (#25 – #48)
	1 – 50A(#301)		1 – 50A(#302)
	1 – DMX output		1 – DMX output

FOH Box Booms:

Each are mounted on the auditorium sidewall, approximately 39° to either side of the proscenium centerline.

50'-0" throw from box boom to person standing at proscenium line, center center.

Throw angle is 26° from box boom to person standing at proscenium line, center center.

Each has surface mount, vertical connector strip with flush mount, pin plug receptacles.

Stage Left:	12 – 20A (#49 - #60)	Stage Right:	12 – 20A (#61 – #72)
	1 – DMX output		1 – DMX output

STRAND-CAPITOL PERFORMING ARTS CENTER

FOH Balcony Rail:

81'-0" throw to person standing at proscenium line, center center.
Throw angle is approximately 7° from rail to person standing at proscenium line, center center.
Each outlet box is recess mounted with flush mount pin plug receptacles.

12 – 20A (#73 - #84)
2 – 50A (#303, #304)
4 – DMX outputs

Proscenium:

Outlet boxes are located on proscenium wall, 27'-0" above apron.
Each outlet box is recess mounted with flush mount pin plug receptacles.

Stage Left: 3 – 20A(#85 - #87) Stage Right: 3 – 20A(#88 – #90)
 1 – DMX output 1 – DMX output

Onstage Electric Pipes:

Each has pipe mounted connector strips with flush mount pin plug receptacles

#1 Electric Pipe: 36 – 20A (#91 – #126) 4'-0" from plaster line
#2 Electric Pipe: 24 – 20A (#127 – #150) 10'-8" from plaster line
#3 Electric Pipe: 24 – 20A (#151 – #174) 16'-0" from plaster line
#4 Electric Pipe: 24 – 20A (#175 – #198) 21'-4" from plaster line
#5 Electric Pipe: 24 – 20A (#199 – #222) 28'-0" from plaster line

Fly Floors:

Outlet boxes with flush mount pin plug receptacles are surface mounted on fly floor side of pin rail.

Stage Left: 6 – 20A (#223 - #228) 6'-4" from plaster line
 6 – 20A (#229 - #234) 14'-0" from plaster line
 6 – 20A (#235 - #240) 18'-6" from plaster line
 6 – 20A (#241 - #246) 24'-8" from plaster line
 1 – 50A (#305) 34'-0" from plaster line
 2 – DMX outputs

Stage Right: 6 – 20A (#247 - #252) 6'-4" from plaster line
 6 – 20A (#253 - #258) 14'-0" from plaster line
 6 – 20A (#259 - #264) 18'-6" from plaster line
 6 – 20A (#265 - #270) 24'-8" from plaster line
 1 – 50A (#306) 34'-0" from plaster line
 2 – DMX outputs

Stage Level:

Outlet boxes are surface mounted with flush mount pin plug receptacles.

Stage Left: 6 – 20A(#271 - #276) Stage Right: 6 – 20A(#283 – #288)
 6 – 20A(#277 - #282) 6 – 20A(#289 - #294)
 4 – DMX outputs 4 – DMX outputs

STRAND-CAPITOL PERFORMING ARTS CENTER

Orchestra Pit:

Outlet boxes are surface mounted with flush mount pin plug receptacles.

6 – 20A (#295 - #300)

1 – DMX output

STAGE LIGHTING FIXTURES:

24-ETC Source Four 10deg. on balcony rail

9-ETC Source Four 19deg. on each box boom and 15 on each lighting Perch, all with HPL/750-115x lamp.

Loose inventory 6-ETC Source Four 19deg.

42-ETC Source Four 26deg

72-ETC Source Four 36deg.

20-ETC Source Four 50deg.

12-ETC Source Four Par w/HPL/750-115x

24-Altman Par64 1k W,M,N or VN lamp

8-Altman Sky-Cyc 3-cell 1k

8-Altman GC-6 ground row 3-circuit 500w.

Note: All ETC have HPL/575-115x lamp unless noted.

Follow Spots: 2-Lycian #1290 XLT Long Throw with 2k Xenon lamp

8-14' Pipe and 75lb. boom base

COMPANY SWITCHES:

Each company switch has a 100% rated breaker, cam-lok connectors and a lug connection area.

1	400A	Stage machinery	Upstage wall, stage left
1	100A	Sound (isolated ground)	Down Stage left
2	400A	Stage lighting	Stage right scenery dock
2	400A	Stage lighting	Stage right fly floor (in parallel with stage level stage lighting company switches)
1	400A	Stage machinery	Stage right fly floor

SOUND SYSTEM:

FOH and Monitor Equipment

- 1 Midas Verona V240/8/IP 24 X 8 Mixing Console
- 2 Klark-Teknik DN360 1/3 Oct EQ (for monitors or inserting)
- 1 Presonus ACP-88 8 channel compressor/gate
- 1 Klark-Teknik DN500 2 Channel Comp/Limiter
- 1 Lexicon PCM 80 EFX
- 1 Yamaha SPX 990 EFX
- 1 Yamaha SPX 1000 EFX
- 1 Goldline RTA w/ mic
- 1 Sony DTC A7 DAT
- 1 Marantz PMD 350 CD/Cassette Deck
- 2 Furman PL8 Power/Light Units
- 6 EAW SM155HI Passive 15" w/horn monitor (2 – mixes from house console)
- 1 Sennheiser Infrared Listening System w/ 4-emitter panels
- 72 Mic lines to FOH...24 from SL, 24 from SR, 24 from orchestra pit

SPEAKER SYSTEM

- 3 Clair Bros Cat-2 3-way compact line array Full Range Mono Center Cluster
 - 6 Clair Bros RC-80 Front Fills (Portable – used as needed)
 - 8 Clair Bros CS-18 SubBass Speakers (Portable – used as needed)
 - 1 DSP Processor BSS-9088ii for above system
 - 6 Clair Bros. UB2003 Under Balcony Speakers
 - 1 DSP Processor BSS-9088ii for Under Balcony System
- All powered by CBX-700, 900 and 1100 power amps

STRAND-CAPITOL PERFORMING ARTS CENTER

MISC. EQUIPMENT

Miscellaneous SHURE, AKG and SENNHEISER Microphones as needed.

Miscellaneous Mic Stands, Booms, Cables and Sub-Snakes as needed.

1 Dressing Room Monitor and Call System

1 Infrared Video Distribution System (1-Camera on balcony rail & 1-Stage Left)

CLEAR-COM SYSTEM

2 RCS-2000 Assignment Units

1 CS-210 Power Supply

10 CC-95 Single Muff Headsets with RS-501 Beltpack

DRESSING ROOMS:

Stage Level:

2 2 person (Star), each with toilet and shower

Basement Level (Under Stage):

2 12 person (Chorus), each with 2 toilets and 2 showers

2 4 person (Principal), each with toilet and shower

Wardrobe Room with 2 washers and 2 dryers, 2 steamers, irons and ironing boards.

Production Office:

2 Telephone lines

1 Plain paper fax machine

Phone Line Numbers are as follows:

Port 011A – 717-505-3100

Port 011B – 717-505-3098

Port 011C – 717-505-3099

ORCHESTRA PIT COVER: Wenger pit cover manual install and remove. Set at stage level, or out for orchestra. (We do not seat the pit cover)

STRAND-CAPITOL PERFORMING ARTS CENTER

Drawn by: _____
Checked by: _____

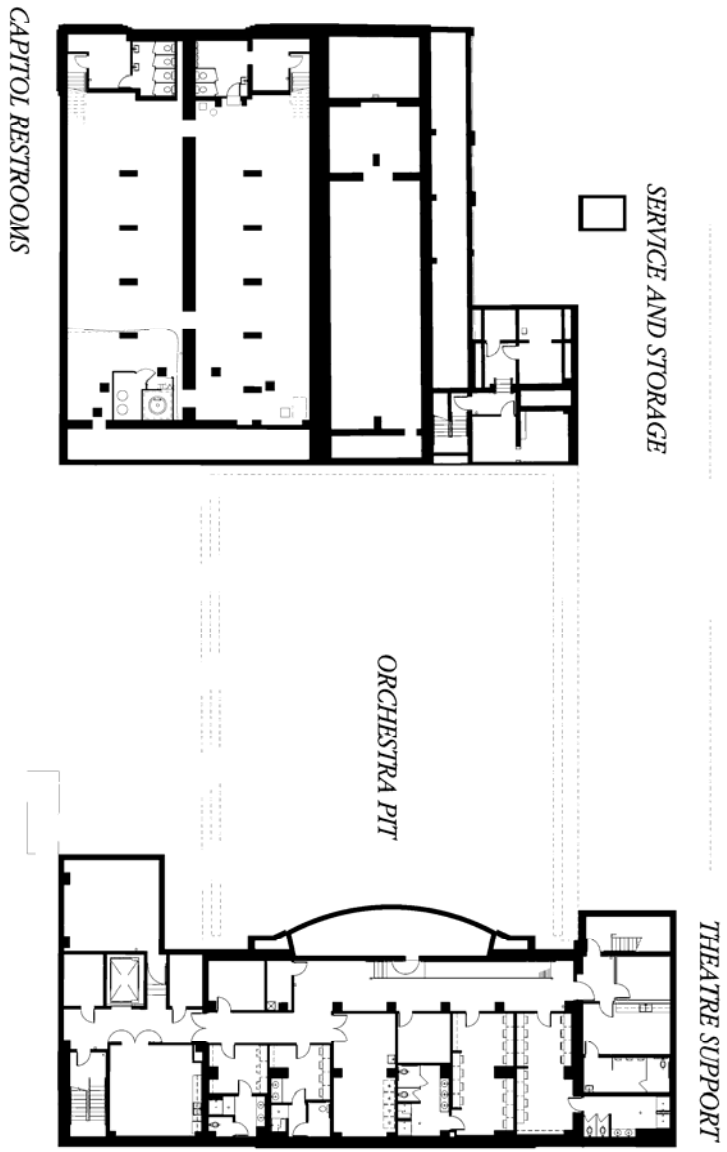

Room / Feature	Area	Notes

NEW
ADAPTIVE RE-USE
RENOVATED

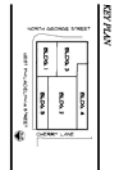

Basement Level Plan

Commission #0003
50 South Orange Street
New York, NY
van Dyke Architects Reed Architects
Architects
The Shakespeare Building
100 West Broadway
New York, NY 10038
212.253.2525

Basement Level Plan
CD
A1-1

STRAND-CAPITOL PERFORMING ARTS CENTER

Drawn by _____
Checked by _____

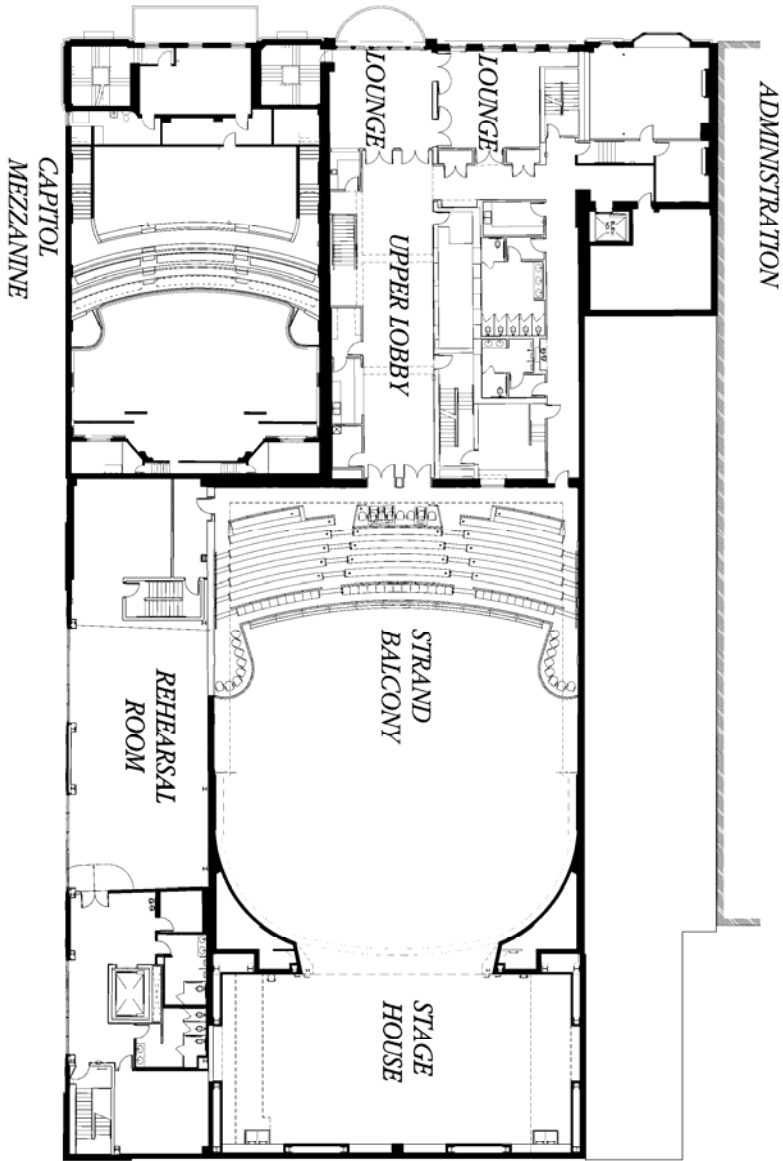

MEZZANINE LEVEL, R. 2, 3, 4, 5, 6, 7, 8, 9, 10, 11, 12, 13, 14, 15, 16, 17, 18, 19, 20, 21, 22, 23, 24, 25, 26, 27, 28, 29, 30, 31, 32, 33, 34, 35, 36, 37, 38, 39, 40, 41, 42, 43, 44, 45, 46, 47, 48, 49, 50, 51, 52, 53, 54, 55, 56, 57, 58, 59, 60, 61, 62, 63, 64, 65, 66, 67, 68, 69, 70, 71, 72, 73, 74, 75, 76, 77, 78, 79, 80, 81, 82, 83, 84, 85, 86, 87, 88, 89, 90, 91, 92, 93, 94, 95, 96, 97, 98, 99, 100

True
Project

CD
A1.3

Strand-Capitol Performing Arts Center
Commission #100113
30 South Orange Street
New York, NY
van Dyke Residential Real Estate
architects
110 West 42nd Street
New York, NY 10018
212.250.1000
www.vandyke.com

MEZZANINE LEVEL
Second Floor Plan

LEGEND
NEW
ADAPTIVE RE-USE
RENOVATED

KEY PLAN
BLOCK 1
BLOCK 2
BLOCK 3
BLOCK 4
BLOCK 5
BLOCK 6
BLOCK 7
BLOCK 8
BLOCK 9
BLOCK 10
BLOCK 11
BLOCK 12
BLOCK 13
BLOCK 14
BLOCK 15
BLOCK 16
BLOCK 17
BLOCK 18
BLOCK 19
BLOCK 20
BLOCK 21
BLOCK 22
BLOCK 23
BLOCK 24
BLOCK 25
BLOCK 26
BLOCK 27
BLOCK 28
BLOCK 29
BLOCK 30
BLOCK 31
BLOCK 32
BLOCK 33
BLOCK 34
BLOCK 35
BLOCK 36
BLOCK 37
BLOCK 38
BLOCK 39
BLOCK 40
BLOCK 41
BLOCK 42
BLOCK 43
BLOCK 44
BLOCK 45
BLOCK 46
BLOCK 47
BLOCK 48
BLOCK 49
BLOCK 50
BLOCK 51
BLOCK 52
BLOCK 53
BLOCK 54
BLOCK 55
BLOCK 56
BLOCK 57
BLOCK 58
BLOCK 59
BLOCK 60
BLOCK 61
BLOCK 62
BLOCK 63
BLOCK 64
BLOCK 65
BLOCK 66
BLOCK 67
BLOCK 68
BLOCK 69
BLOCK 70
BLOCK 71
BLOCK 72
BLOCK 73
BLOCK 74
BLOCK 75
BLOCK 76
BLOCK 77
BLOCK 78
BLOCK 79
BLOCK 80
BLOCK 81
BLOCK 82
BLOCK 83
BLOCK 84
BLOCK 85
BLOCK 86
BLOCK 87
BLOCK 88
BLOCK 89
BLOCK 90
BLOCK 91
BLOCK 92
BLOCK 93
BLOCK 94
BLOCK 95
BLOCK 96
BLOCK 97
BLOCK 98
BLOCK 99
BLOCK 100