

# STRAND-CAPITOL PERFORMING ARTS CENTER

50 N George St  
York, PA 17401  
(P) 717-846-1155 (F) 717-843-1208  
[www.strandcapitol.org](http://www.strandcapitol.org)

## 11-15-07 TECHNICAL INFORMATION

**TECHNICAL CONTACT:** Production Express, Inc. Steven Shelley (P) 717-854-5265 (F) 717-843-7031  
E-mail: [salesinfo@proexp.com](mailto:salesinfo@proexp.com)  
Production Manager: Judi Miller (P) 717-495-8761 (F) 717-843-7031  
E-mail: [iatsepejudi@yahoo.com](mailto:iatsepejudi@yahoo.com)

### GENERAL INFORMATION:

Proscenium Width: 42'-0"

Proscenium Height: 28'-0" to masonry  
21'-6" to Grand Drape/Valance

Stage Depth: 37'-1" smoke pocket to upstage wall  
37'-8" proscenium line to upstage wall

Stage Width: 77'-5" stage left wall to stage right wall  
74'-5" stage left locking rail to stage right wall  
14'-11" proscenium line to stage left locking rail  
17'-6" proscenium line to stage right wall  
35'-11" centerline to stage left locking rail  
38'-6" centerline to stage right wall  
29'-0" centerline to edge of stage left fly floor  
29'-5" centerline to edge of stage right fly floor  
58'-5" edge of stage left fly floor to edge of stage right fly floor

Stage Apron: 4'-0" proscenium line to edge of apron

Orchestra Pit: Approximate capacity of 23 musicians  
8'-3" below stage  
10'-7" deep at centerline, 5'-0" deep at sides, extends 3'-0" under stage  
42'-6" wide

Fly Floors: 35'-0" above stage  
26'-9" clear from stage to AC duct under stage left fly floor  
25'-9" clear from stage to AC duct under stage right fly floor

Grid Iron: 70'-0" above stage

Scene Dock: Accessible stage right through a 12'-0" wide by 19'-0" high roll-up door, the 34'-0" long by 18'-0" wide-open area can be used for load-in/out staging or as additional scenery storage.

Loading Door: 10'-0" wide x 12'-0" high, at street level, stage right.

### STAGE RIGGING SYSTEM:

Forty-nine (49) five-line, tee-bar guided, single purchase line sets, each with 1900# capacity, on 8" centers, operated from stage left. Each line set has a 52'-0" long truss batten.

Fire curtain is located 3" upstage of proscenium.

## STRAND-CAPITOL PERFORMING ARTS CENTER

House curtain is located 1'-3" upstage of proscenium.

Line set #1 is located 2'-0" upstage of proscenium.

Line set #49 is located 37'-4" upstage of proscenium.

Line set low trim is 4'-0".

Line set high trim is 65'-0".

50,000# of counterweight is on hand. This includes pipe counterweight on each line set.

Misc. rigging equipment:

15 8" diameter, 3 sheave, upright hemp headblocks

40 8" diameter, upright hemp loft blocks

20 8" diameter, upright, cable loft blocks

Misc. 5/8" diameter Multiline II synthetic rope

### STAGE DRAPERY:

|    |  |             |             |
|----|--|-------------|-------------|
| 2  | Travelers, black velour, with 50% fullness | 28'-0" high | 52'-0" wide |
| 6  | Borders, black velour, sewn flat           | 15'-0" high | 52'-0" wide |
| 12 | Legs, black velour, sewn flat              | 28'-0" high | 8'-0" wide  |
| 1  | Scrim, black, seamless sharktooth          | 28'-0" high | 52'-0" wide |
| 1  | Cyclorama, seamless bleached muslin,       | 28'-0" high | 52'-0" wide |

### STAGE LIGHTING DIMMING SYSTEM:

300 – 2.4 kW and 8 – 6.0 kW ETC *Sensor* dimmers in dimmer-per-circuit racks.

ETC Expression 3, 400 channel stage lighting control console.

### STAGE LIGHTING CIRCUIT DISTRIBUTION:

FOH Ceiling "Perches":

Each is a 12'-8" x 4'-4" platform suspended from the auditorium ceiling.

Each is located 30° to either side of the proscenium centerline.

58'-6" throw from center of perch to person standing at proscenium line, center center.

Throw angle is 39° from center of perch to person standing at proscenium line, center center.

Each has surface mount, vertical connector strip with flush mount, pin plug receptacles.

|             |                     |              |                      |
|-------------|---------------------|--------------|----------------------|
| Stage Left: | 24 – 20A (#1 - #24) | Stage Right: | 24 – 20A (#25 – #48) |
|             | 1 – 50A(#301)       |              | 1 – 50A(#302)        |
|             | 1 – DMX output      |              | 1 – DMX output       |

FOH Box Booms:

Each are mounted on the auditorium sidewall, approximately 39° to either side of the proscenium centerline.

50'-0" throw from box boom to person standing at proscenium line, center center.

Throw angle is 26° from box boom to person standing at proscenium line, center center.

Each has surface mount, vertical connector strip with flush mount, pin plug receptacles.

|             |                      |              |                      |
|-------------|----------------------|--------------|----------------------|
| Stage Left: | 12 – 20A (#49 - #60) | Stage Right: | 12 – 20A (#61 – #72) |
|             | 1 – DMX output       |              | 1 – DMX output       |

## STRAND-CAPITOL PERFORMING ARTS CENTER

### FOH Balcony Rail:

81'-0" throw to person standing at proscenium line, center center.  
Throw angle is approximately 7° from rail to person standing at proscenium line, center center.  
Each outlet box is recess mounted with flush mount pin plug receptacles.

12 – 20A (#73 - #84)  
2 – 50A (#303, #304)  
4 – DMX outputs

### Proscenium:

Outlet boxes are located on proscenium wall, 27'-0" above apron.  
Each outlet box is recess mounted with flush mount pin plug receptacles.

Stage Left: 3 – 20A(#85 - #87)                      Stage Right: 3 – 20A(#88 – #90)  
                  1 – DMX output    1 – DMX output

### Onstage Electric Pipes:

Each has pipe mounted connector strips with flush mount pin plug receptacles

#1 Electric Pipe: 36 – 20A (#91 – #126) 4' – 0" from plaster line  
#2 Electric Pipe: 24 – 20A (#127 – #150) 10' – 8" from plaster line  
#3 Electric Pipe: 24 – 20A (#151 – #174) 16' – 0" from plaster line  
#4 Electric Pipe: 24 – 20A (#175 – #198) 21' - 4" from plaster line  
#5 Electric Pipe: 24 – 20A (#199 – #222) 28' – 0" from plaster line

### Fly Floors:

Outlet boxes with flush mount pin plug receptacles are surface mounted on fly floor side of pin rail.

Stage Left: 6 – 20A (#223 - #228) 6' – 4" from plaster line  
                  6 – 20A (#229 - #234) 14' – 0" from plaster line  
                  6 – 20A (#235 - #240) 18' – 6" from plaster line  
                  6 – 20A (#241 - #246) 24' – 8" from plaster line  
                  1 – 50A (#305) 34' – 0" from plaster line  
                  2 – DMX outputs

Stage Right: 6 – 20A (#247 - #252) 6' – 4" from plaster line  
                  6 – 20A (#253 - #258) 14' – 0" from plaster line  
                  6 – 20A (#259 - #264) 18' – 6" from plaster line  
                  6 – 20A (#265 - #270) 24' – 8" from plaster line  
                  1 – 50A (#306) 34' – 0" from plaster line  
                  2 – DMX outputs

### Stage Level:

Outlet boxes are surface mounted with flush mount pin plug receptacles.

Stage Left: 6 – 20A(#271 - #276)                      Stage Right: 6 – 20A(#283 – #288)  
                  6 – 20A(#277 - #282)    6 – 20A(#289 - #294)  
                  4 – DMX outputs    4 – DMX outputs

## STRAND-CAPITOL PERFORMING ARTS CENTER

### Orchestra Pit:

Outlet boxes are surface mounted with flush mount pin plug receptacles.

6 – 20A (#295 - #300)

1 – DMX output

### STAGE LIGHTING FIXTURES:

24-ETC Source Four 10deg. on balcony rail

9-ETC Source Four 19deg. on each box boom and 15 on each lighting Perch, all with HPL/750-115x lamp.

Loose inventory 6-ETC Source Four 19deg.

42-ETC Source Four 26deg

72-ETC Source Four 36deg.

20-ETC Source Four 50deg.

12-ETC Source Four Par w/HPL/750-115x

24-Altman Par64 1k W,M,N or VN lamp

8-Altman Sky-Cyc 3-cell 1k

8-Altman GC-6 ground row 3-circuit 500w.

Note: All ETC have HPL/575-115x lamp unless noted.

Follow Spots: 2-Lycian #1290 XLT Long Throw with 2k Xenon lamp

8-14' Pipe and 75lb. boom base

### COMPANY SWITCHES:

Each company switch has a 100% rated breaker, cam-lok connectors and a lug connection area.

|   |      |                         |  |
|---|------|-------------------------|--|
| 1 | 400A | Stage machinery         | Upstage wall, stage left   |
| 1 | 100A | Sound (isolated ground) | Down Stage left  |
| 2 | 400A | Stage lighting          | Stage right scenery dock   |
| 2 | 400A | Stage lighting          | Stage right fly floor (in parallel with stage level stage lighting company switches) |
| 1 | 400A | Stage machinery         | Stage right fly floor  |

### SOUND SYSTEM:

#### FOH and Monitor Equipment

- 1 Midas Verona V240/8/IP 24 X 8 Mixing Console
- 2 Klark-Teknik DN360 1/3 Oct EQ (for monitors or inserting)
- 1 Protea 424G - 4 Channel Graphic EQ
- 1 Presonus ACP-88 8 channel compressor/gate
- 1 Klark-Teknik DN500 2 Channel Comp/Limiter
- 1 Lexicon PCM 80 EFX
- 1 Yamaha SPX 990 EFX
- 1 Goldline RTA w/ mic
- 1 Sony DTC A7 DAT
- 1 Tascam 500 CD/Tape Player
- 1 Furman PL8 Power/Light Units
- 4 EAW SM155HI Passive 15" w/horn monitor (2 – mixes from house console)
- 1 Sennheiser Infrared Listening System w/ 4-emitter panels
- 72 Mic lines to FOH...24 from SL, 24 from SR, 24 from orchestra pit

#### SPEAKER SYSTEM

- 3 Clair Bros Cat-2 3-way compact line array Full Range Mono Center Cluster
- 6 Clair Bros RC-80 Front Fills (Portable – used as needed)
- 8 Clair Bros CS-18 SubBass Speakers (Portable – used as needed)
- 1 DSP Processor BSS-9088ii for above system
- 6 Clair Bros. UB2003 Under Balcony Speakers
- 1 DSP Processor BSS-9088ii for Under Balcony System

## **STRAND-CAPITOL PERFORMING ARTS CENTER**

All powered by CBX-700, 900 and 1100 power amps

### **MISC. EQUIPMENT**

Miscellaneous SHURE, AKG and SENNHEISER Microphones as needed.

Miscellaneous Mic Stands, Booms, Cables and Sub-Snakes as needed.

- 1 Dressing Room Monitor and Call System
- 1 Infrared Video Distribution System (1-Camera on balcony rail & 1-Stage Left)

### **CLEAR-COM SYSTEM**

- 2 RCS-2000 Assignment Units
- 1 CS-210 Power Supply
- 10 CC-95 Single Muff Headsets with RS-501 Beltpack

### **DRESSING ROOMS:**

Stage Level:

- 2 2 person (Star), each with toilet and shower

Basement Level (Under Stage):

- 2 12 person (Chorus), each with 2 toilets and 2 showers
- 2 4 person (Principal), each with toilet and shower

Wardrobe Room with 2 washers and 2 dryers, 2 steamers, irons and ironing boards.

Production Office:

- 2 Telephone lines
- 1 Plain paper fax machine

Phone Line Numbers are as follows:

Port 011A – 717-505-3100

Port 011B – 717-505-3098

Port 011C – 717-505-3099

**ORCHESTRA PIT COVER:** Wenger pit cover manual install and remove. Set at stage level, or out for orchestra. (We do not seat the pit cover)





# STRAND-CAPITOL PERFORMING ARTS CENTER

Drawn by: \_\_\_\_\_  
 Checked by: \_\_\_\_\_

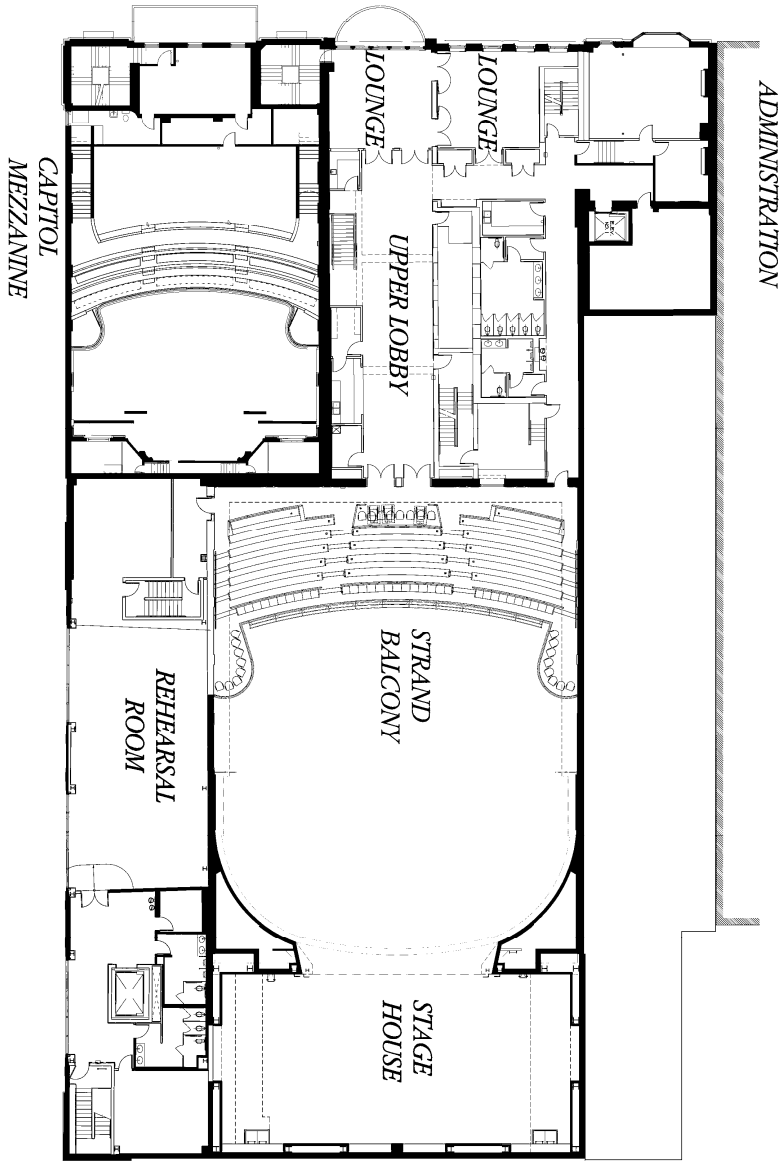

MEZZANINE LEVEL PLAN

True North  
 Project

CD  
 A1.3

Strand-Capitol Performing Arts Center

Commission # 00112

50 North George Street

10th Dyke Westside Rowdiesky Architects

The Performing Building 300  
 Cleveland Ohio 44115-4612  
 216.262.1200

Mezzanine Level/  
 Second Floor Plan

| Revised / Proposed | No. | Date | Description |
|--------------------|-----|------|-------------|
|                    |     |      |             |
|                    |     |      |             |
|                    |     |      |             |
|                    |     |      |             |
|                    |     |      |             |
|                    |     |      |             |
|                    |     |      |             |
|                    |     |      |             |
|                    |     |      |             |

Legend  
 NEW  
 ADAPTIVE RE-USE  
 RENOVATED

